

# ARCHITECTS IN RESIDENCE: EXAMPLES OF STUDENT TASKS AND OUTPUTS PRIMARY, SECONDARY, 14 -19 YEARS

## AN ARTISTIC RESPONSE

2D

3D

## DESIGN PROPOSAL

Proposal for a structure

Proposal for a scheme

Proposal for a piece of public art

Proposal for branding an area

Proposal for a system

## COMMENTARY

Film

Written critique or analysis

Presentation

ARTISTIC RESPONSE  
Curriculum Focus  
Aim

2D  
GCSE Fine Art  
To show Kings Cross past and present



*Architects in Residence, Kings Cross 2006, Maria Fidelis Convent School with Burrell Foley Fischer Architects*

## ARTISTIC RESPONSE 2D

Curriculum focus

Aim

AS Photography, A2 Fine Art, A2 3D Design (Cross-curricular group)

To make proposals showing what should be done about the gasometers



ARTISTIC RESPONSE

3D

Curriculum focus

AS Photography, A2 Fine Art, A2 3D Design (Cross-curricular group)

Aim

To make proposals showing what should be done about the gasometers



*Architects in Residence, Kings Cross 2006, City & Islington Sixth Form College with Wilkinson Eyre Architects:*

## DESIGN PROPOSAL

Curriculum focus

Aim

## A PROPOSAL FOR A STRUCTURE

Citizenship, Geography, Design and Technology

To make an outdoor learning area out of recycled materials



*Architects in Residence, Designing a Greener London 2007, Heronsgate Primary School with Burd Haward Architects*

DESIGN PROPOSAL  
Curriculum focus  
Aim

A PROPOSAL FOR A STRUCTURE  
Design and Technology, Science, and Geography (collaboration)  
To design an eco learning pod on the school roof



*Architects in Residence, Designing a greener London 2007, Westminster City School with Wilkinson Eyre Architects*

# DESIGN PROPOSAL

Curriculum focus

Aim

# A PROPOSAL FOR A STRUCTURE

GCSE Design and Technology

To reinvent the Islington Triangle

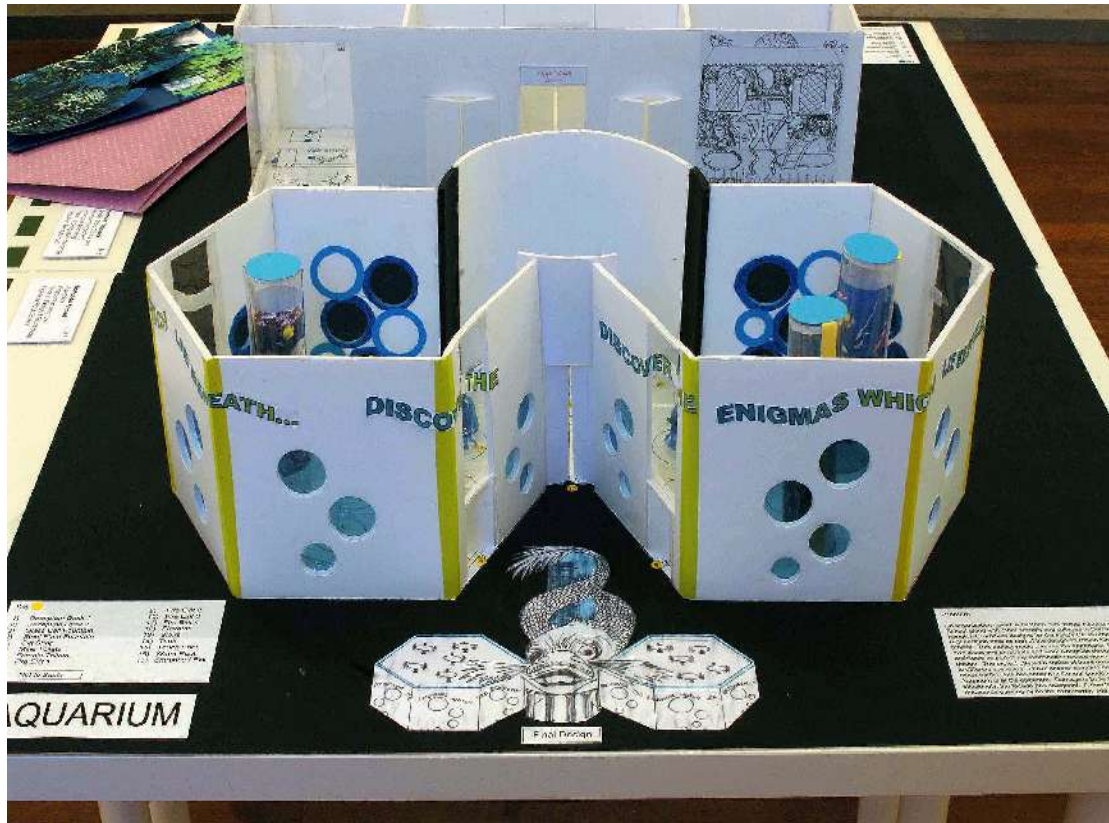

*Architects in Residence, Kings Cross 2006, Highbury Fields School with David Morley Architects*

## DESIGN PROPOSAL

Curriculum focus

Aim

## A PROPOSAL FOR A STRUCTURE

GCSE Design and Technology

To reinvent the Islington Triangle

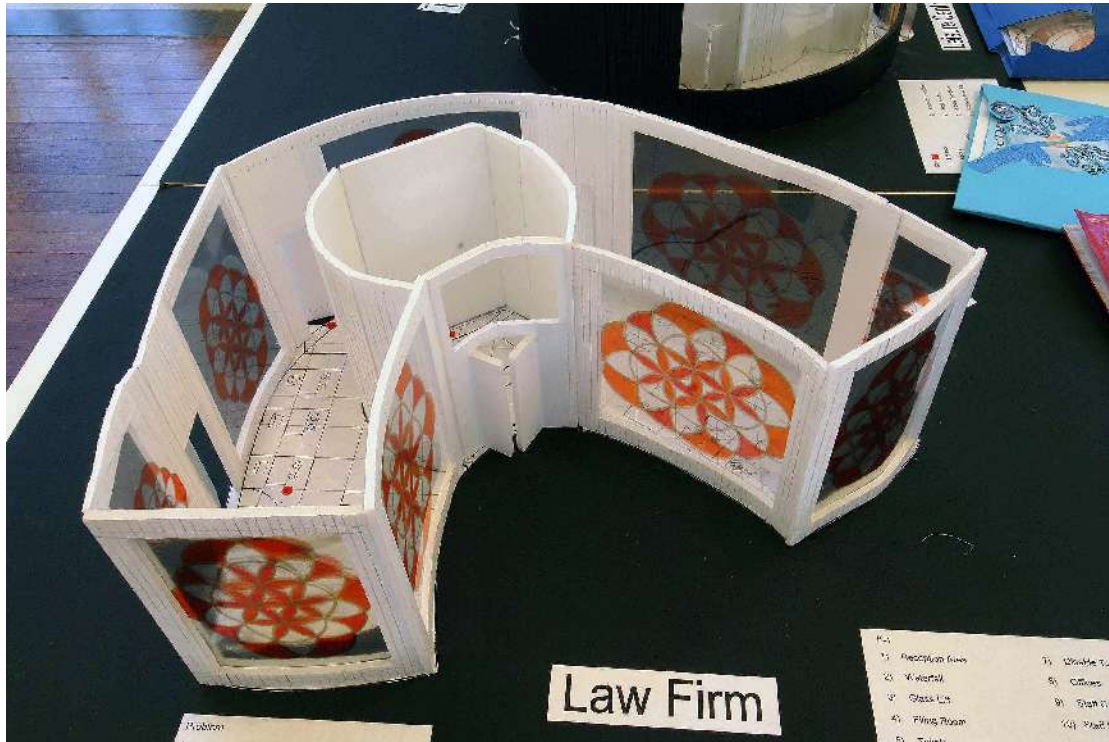

*Architects in Residence, Kings Cross 2006, Highbury Fields School with David Morley Architects*

## DESIGN PROPOSAL A PROPOSAL FOR A STRUCTURE

Curriculum focus: AS Photography, A2 Fine Art, A2 3D Design (Cross-curricular group)

Aim

To make proposals showing what should be done about the gasometers



*Architects in Residence, Kings Cross 2006, City & Islington Sixth Form College with Wilkinson Eyre Architects*

## DESIGN PROPOSAL

Curriculum focus

Aim

## A PROPOSAL FOR A SCHEME

Art and Design

To design environmentally friendly furniture for the playground



*Architects in Residence, Designing a Greener London 2007, Curwen Primary School with erect architecture*

## DESIGN PROPOSAL

Curriculum focus:

Aim:

## A PROPOSAL FOR A SCHEME

Design and Technology, Arts, Maths Science

To design ways to regenerate the wildlife area in the playground

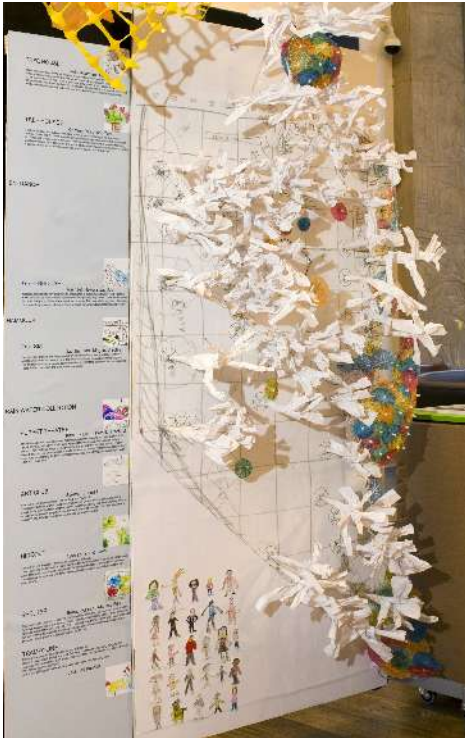

*Architects in Residence, Designing a Greener London 2007, Kidbrooke Primary School with Avanti Architects*

## A DESIGN PROPOSAL

Curriculum focus

Aim

## A PROPOSAL FOR A SCHEME

Geography, Design and Technology

To examine ways of improving the local area around the school



*Architects in Residence, Designing a Greener London 2007, Malmesbury Primary School with AOC Architecture*

## DESIGN PROPOSAL

Curriculum focus

Aim

## A PROPOSAL FOR A SCHEME

Art and Design

To design an environmentally friendly dance and music studio and café in the school grounds with its own water bottling plant



*Architects in Residence, Designing a Greener London 2007, Crown Woods School with Brady Mallalieu Architects*

## DESIGN PROPOSAL

Curriculum focus

Aim

## A PROPOSAL FOR A SCHEME

An extra-curricular group of different ages

To develop Goods Yard

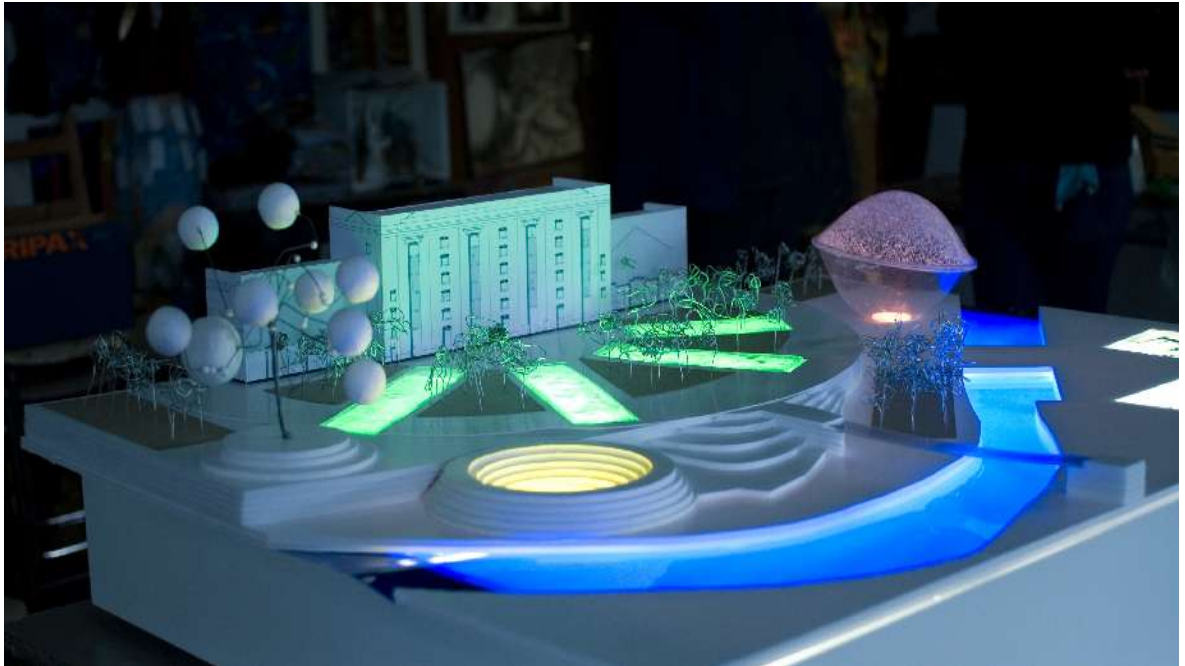

*Architects in Residence, Kings Cross 2006, Hampstead School with Stanton Williams Architects*

## DESIGN PROPOSAL

Curriculum focus

Aim

## A PROPOSAL FOR A PIECE OF PUBLIC ART

GCSE Art and Design

To create a personal response to the future of York Way



*Architects in Residence, Kings Cross 2006, Islington Green School with Allford Hall Monaghan Morris Architects*

## DESIGN PROPOSAL

Curriculum focus

Aim

## A PROPOSAL FOR A PIECE OF PUBLIC ART

AS Photography, A2 Fine Art, A2 3D Design (Cross-curricular group)

To make proposals showing what should be done about the gasometers



*Architects in Residence, Kings Cross 2006, City & Islington Sixth Form College with Wilkinson Eyre Architects*

DESIGN PROPOSAL  
Curriculum focus  
Aim

A PROPOSAL FOR BRANDING AN AREA  
GCSE Design and Technology  
To create a brand for a site within the Kings Cross Development

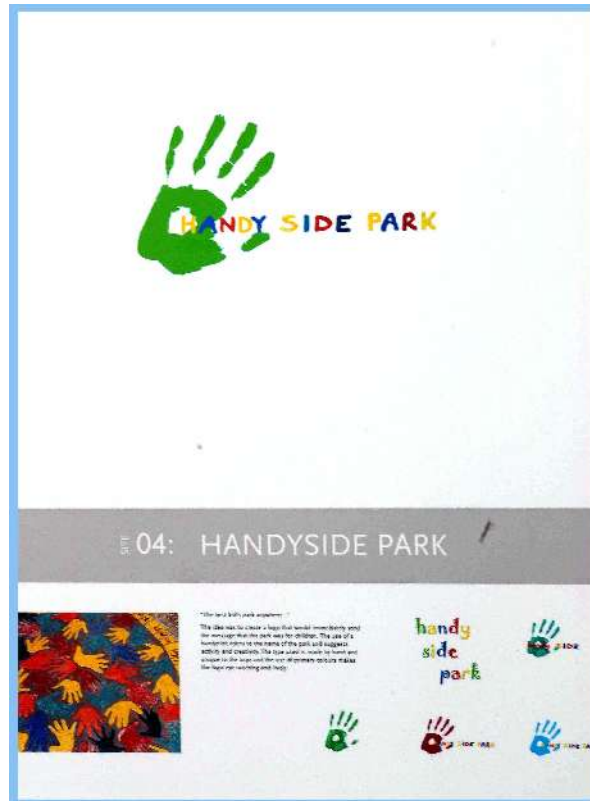

*Architects in Residence, Kings Cross 2006, South Camden Community School with David Chipperfield Architects*

## DESIGN PROPOSAL

Curriculum focus

Aim

## A PROPOSAL FOR BRANDING AN AREA

AS Graphics

To brand an area in a newsletter looking at local views and needs

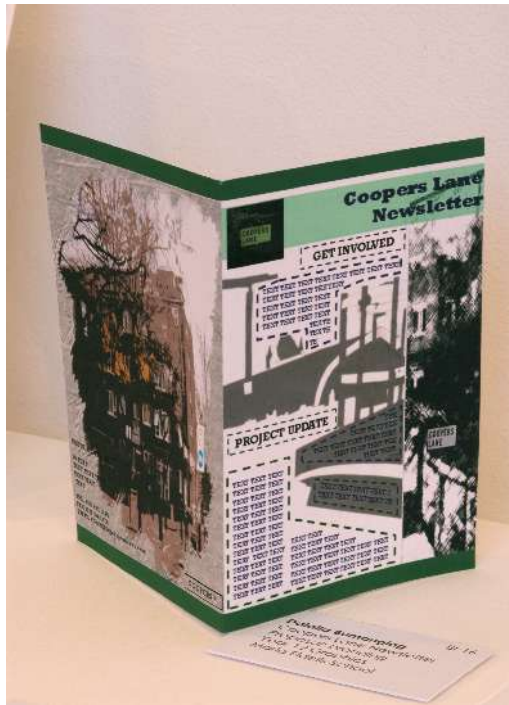

Architects in Residence, Kings Cross 2006, Maria Fidelis School with Burrell Foley Fischer

PROPOSAL  
Curriculum focus:  
Aim

A PROPOSAL FOR A SYSTEM  
Science, Citizenship  
To research and propose improvements to consumption patterns within  
the school

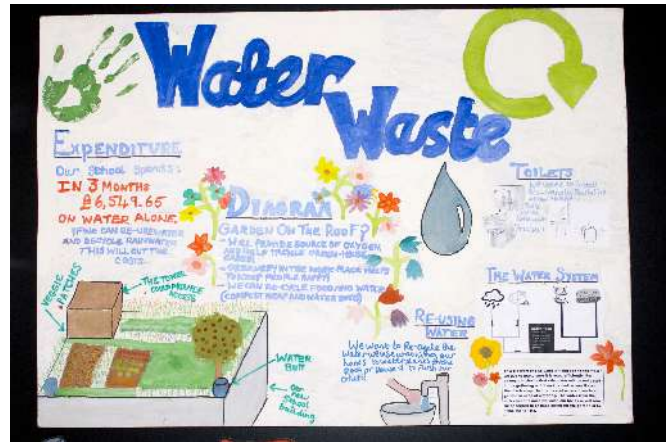
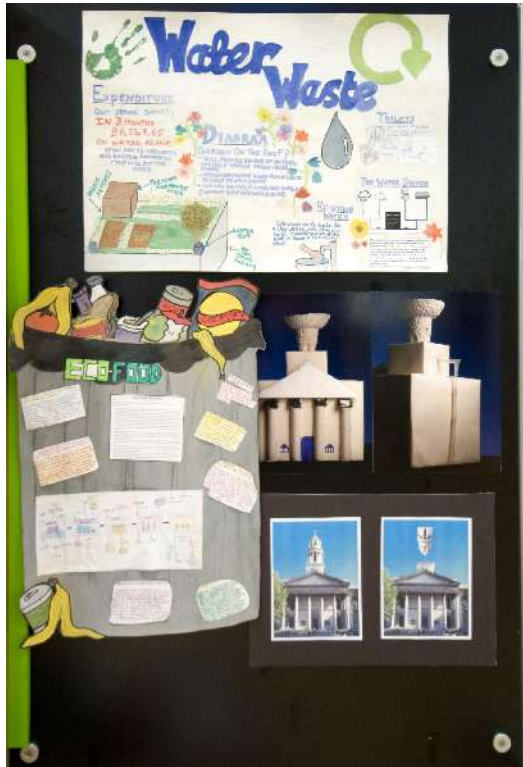

*Architects in Residence, Designing a Greener London 2007, St Marylebone CE School with BDP Architects*

COMMENTARY  
Curriculum focus  
Aim

A FILM  
Art and Design, Citizenship, Media Studies  
To raise awareness of water use in the school by making a film



*Architects in Residence, Designing a Greener London 2007, Charlton Secondary School with Charlick & Nicholson*

COMMENTARY  
Curriculum focus  
Aim

WRITTEN CRITIQUE OR ANALYSIS

*NO IMAGE YET*

*Architects in Residence,*

COMMENTARY  
Curriculum focus  
Aim

A PRESENTATION  
An extra-curricular group of different ages  
To develop Goods Yard



*Architects in Residence, Kings Cross 2006, Hampstead School with Stanton Williams Architects*

COMMENTARY  
Curriculum Focus  
Aim

PRESENTATION  
GCSE Design and Technology  
To create a brand for a site within the Kings Cross Development



*Architects in Residence, Kings Cross 2006, South Camden Community School with David Chipperfield Architects*

COMMENTARY  
Curriculum Focus  
Aim

PRESENTATION  
AS Photography, A2 Fine Art, A2 3D Design (Cross-curricular group)  
To propose a future for the Kings Cross gasometers



*Architects in Residence, Kings Cross 2006, City & Islington Sixth Form College with Wilkinson Eyre Architects*